

Q1.11.6.6 Bedford Borough Council Applicant Sustainable development

Provide further detail and plans to support the comments in your RR regarding access to EWR stations and, space to accommodate other modes of travel on Barford Road overbridge, adjacent to the ECML and under the new road [RR-008a].

Applicant's comments

Bedford BC is concerned that arrangements should be made for a junction on the new road to provide access to the planned East West Rail (EWR) / East Coast Main Line (ECML) interchange station. As the location of that station is still to be determined by EWR, no plans are currently available to show the exactly appropriate layout for such a junction, but EWR has set out four possible station locations as shown on p212 of this document: <https://eastwestrail-production.s3.eu-west-2.amazonaws.com/public/Consultation-Document.pdf>

As a minimum, confirmation is sought that the status of the A428 does not prohibit new junctions on to the new road to serve the chosen station and associated developments in the future.

With development proposed both north and south of the new stations (whichever is chosen), the Council believes that provision should be made for formal sustainable transport routes under the new road where it crosses the East Coast Main Line. This would allow for pedestrians, cyclists and other vulnerable users to travel from the station to the new developments via a segregated, off-road route.

The cross section below shows strips labelled "accommodation access tracks" to the east and west of the ECML. This looks to be land that won't be retained in Highways England's ownership but could be used for foot / cycle routes under the new road, and agreement to retaining these access routes would make good sense.

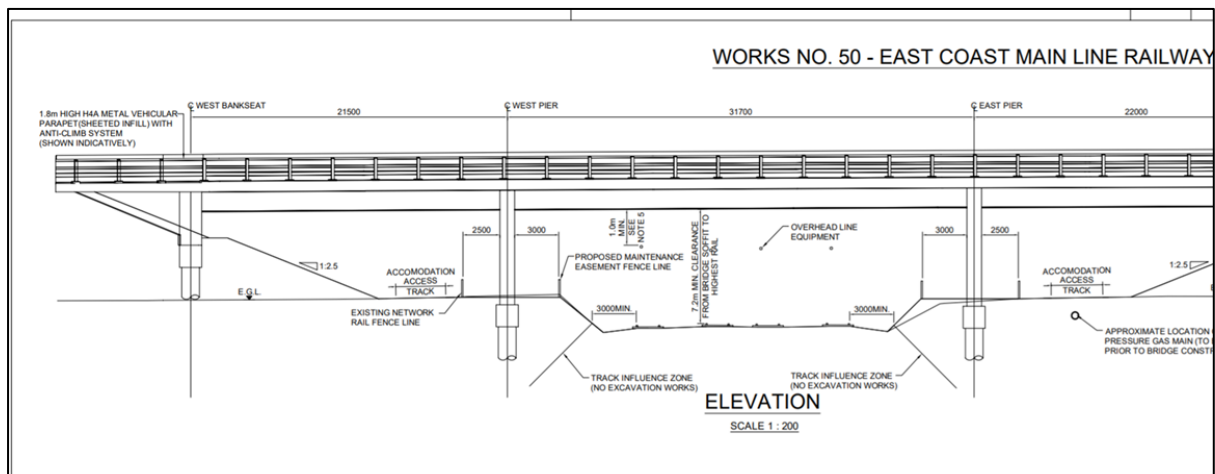

Additionally, it would be sensible for segregated cycle lanes and footpaths to be included on the new / replacement Barford Road overbridge.

